

### TECHNICAL SPECIFICATIONS



L3IP8BDS180S



**L3IP8BDS180S**

### FEATURES:

- ◆ NDAA Compliant
- ◆ Supports AI Face, Body & Vehicle Recognition\*
- ◆ True 120dB Wide Dynamic Range
- ◆ 8MP Resolution (4608x1728)
- ◆ Dual 2.8mm IR Lenses
- ◆ Dual LED - 100' IR / 65' White Light
- ◆ 7 Intelligent Analytics
- ◆ Dual Channel or Splicing Modes
- ◆ 2-Way Audio - Built in Mic/Speaker
- ◆ 256GB SD Card Capability
- ◆ H.265 Recording Compression
- ◆ PoE - Power over Ethernet
- ◆ Onvif Profile S/G/T Compliant
- ◆ IP66 Weatherproof

\*For use with Liberty L3 Series NVRs

### INCLUDED ACCESSORIES:

Item	Qty
Quick start guide	1
Hex wrench	1
Mounting inserts and screws	4
Network cable cover w/gasket	1
4-pin terminal block	1
Mounting Template	1

	FEATURES	L3IP8BDS180S
Camera	Image Sensor	Dual 1/2.8" Progressive Scan CMOS
	Minimum Illumination	Color: 0.01 Lux @ (F1.6,AGC ON)
		B/W: 0.001 Lux @ (F1.6,AGC ON), 0 Lux with light on
	S/N Ratio	55dB
	IR LED Count / White LED Count	2 (IR LED/850nm), 2 (Warm Light)
	IR Range / White Light Range	IR distance up to 30.5m (100ft) / White light distance up to 20m (65ft)
	Shutter Time	Auto/Manual, 1/5 to 1/100,000s
	Lens (IR Corrective)	Dual Fixed-focal lens: 2.8mm / H: 180°, V: 63°
	Camera Bracket Adjustment	Pan: 0° ~ 360°, Tilt: 0° ~ 90°, Rotation: 0° ~ 360°
	Day & Night	Yes - True Day/Night with IR Filter - Auto Switch
	DNR (Digital Noise Reduction)	2DNR & 3DNR, Auto / Manual (0-100 Adjustable)
	True Wide Dynamic Range (120dB)	On / Off (0-100 Adjustable)
	BLC (Backlight Compensation)	On / Off (0-100 Adjustable)
	AI Recognition	* Face, Body & Vehicle Recognition for use with Liberty L3 Series NVRs
	Intelligent Analytic Features	Perimeter, Single Virtual Fence, Double Virtual Fence, Multi Loitering, Wrong Way, People Counting, Smart Motion
	Region of Interest	Yes
	Resolution / Bitrate	Video Compression
Audio Compression		G.711, RAW_PCM
General Functions		Supports Smart IR, Password Protection, Privacy Mask, Motion Detection
Max. Resolution		4608(H) x 1728(V) - 8 Megapixel
Streaming Capability		Dual Streams
Mainstream Resolution		Splicing mode: 4608x1728 @15fps
		Multi-channel mode: 2592x1944, 2592x1520, 1920x1080, 1280x720 @15fps,
Substream Resolution	Splicing mode: 1536x576 @15fps Multi-channel mode: D1, VGA, CIF, QVGA @ 15fps	
Audio Bitrate	64Kbps (G.711), 128Kbps (RAW_PCM)	
Video Bitrate	Splicing mode: Stream1: 500Kbps to 16Mbps, Stream2: 200Kbps to 8Mbps	
	Multi-channel mode: Stream1: 500Kbps to 12Mbps, Stream2: 100Kbps to 6Mbps	
Network	Protocols	IPv4/IPv6, RTSP/RTCP/RTP, TCP/UDP, HTTPS, DHCP, DNS, DDNS, PPPOE, UPnP, IGMP, IGMP, FTP, NTP, STMP, 802.1x, SNMP
	Users	10 Users
	Client Software	Liberty CMS, Liberty-View Mobile App, Liberty Tools
	Web Browser	<IE11, Chrome, Safari, Edge
Interface	Communication Interface	1 Ethernet (10/100 Base-T) RJ-45 Connector
	Audio	1Ch Input/Output (3.5mm) Built in Mic
	Alarm	1Ch Input/Output (Screw Terminal Connector)
	Speaker	Max sound transmission distance of 60m (196.85ft) (45 to 48 dB)
	Reset Button	Yes
	Onboard Storage	Yes Built in Micro SD/SDHC/SDXC slot, up to 256GB
General	Operating Conditions	-30°C to 60°C (-22°F to 140°F)
	Power Supply	DC12V (-15% to +20%) / PoE (IEEE 802.3af)
	Power Consumption & Current	Max 11.5W
	Weatherproof	IP66
	Housing Material / Color	Aluminum / White
	Overall Camera Dimensions	227.7 x 110 x 80 mm (8.96 x 4.33 x 3.15 inch)
	Net Weight	0.82kg (1.81lb)
Certifications	CE / FCC / NDAA	

## L3 Series AI 8MP IP Outdoor Dual Sensor Bullet Camera Dual 2.8mm, True WDR, Dual LED, IP66, PoE



**L3IP8BDS180S**

### Optional Mounting Accessories for L3IP8BDS180S:

#### L3JB1 Junction box

**Features:**

- ◆ Manages & Protects Cables
- ◆ 3/4" Conduit Access
- ◆ For Indoor & Outdoor Use



L3JB1

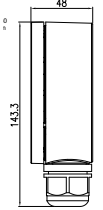
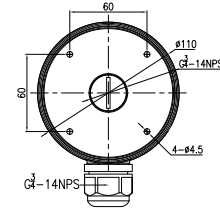
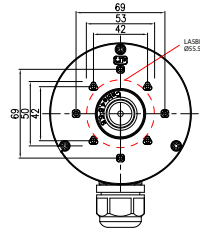

L3JB1 Lineart

#### L3POLEMT2 Pole mount

**Features:**

- ◆ Metal Straps Included
- ◆ For 5-6" Pole Diameters
- ◆ For Indoor & Outdoor Use



L3POLEMT2

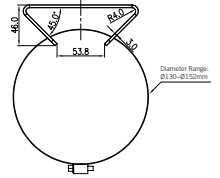
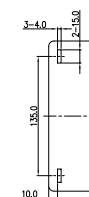
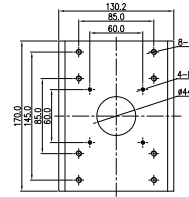

L3POLEMT2 Lineart